

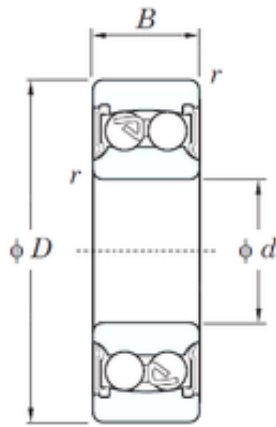

# Air Suspension Bearing Co., Ltd



10 mm x 30 mm x 14 mm KOYO 2200-2RS self aligning ball bearings

Bearing No. 2200-2RS

Size	10x30x14 mm
Bore Diameter	10 mm
Outer Diameter	30 mm
Width	14 mm
d	10 mm
D	30 mm
B	14 mm
C	14 mm
r min.	0.6 mm
da min.	13.7 mm
da max	13.7 mm
Da max.	25 mm
ra max.	0.6 mm
Weight	0.047 Kg
Basic dynamic load rating (C)	5.40 kN
Basic static load rating (C0)	1.20 kN
(Grease) Lubrication Speed	15000 r/min
Calculation factor (e)	0.33
Calculation factor (Y0)	2.01
Calculation factor (Y1)	1.92

2200-2RS Bearing 2D drawings and 3D CAD models