

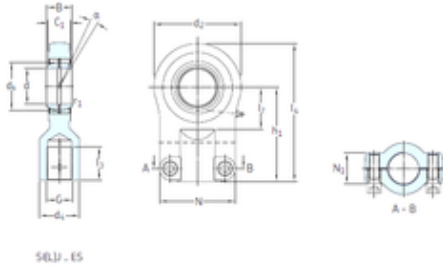

# Air Suspension Bearing Co., Ltd

## SKF SILJ40ES plain bearings



Bearing No. SILJ40ES

Bore Diameter	40 mm
d	40 mm
d2	98 mm
d4 max.	45 mm
dk	53 mm
h1	105 mm
l3 min.	37 mm
l4 max.	155 mm
l7 min.	45 mm
r1 min.	0,6 mm
B	28 mm
C1 max	23 mm
N max	90 mm
N1 max	23 mm
Thread (G)	M27x2 Tolerance 6H
Angle	3 °
Weight	2,4 Kg
Basic dynamic load rating (C)	100 kN

SILJ40ES Bearing 2D drawings and 3D CAD models