

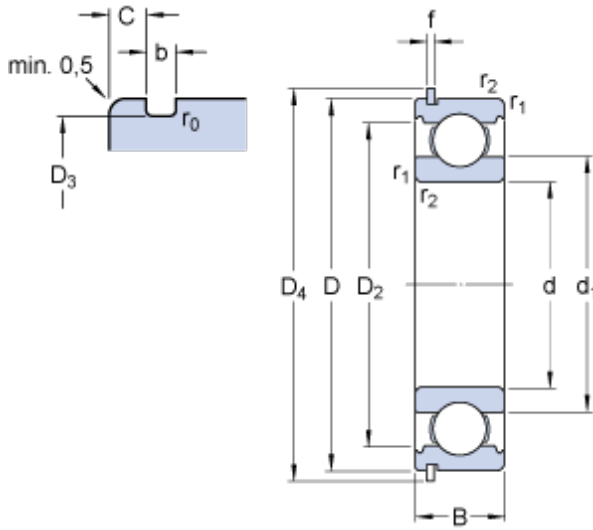

Air Suspension Bearing Co., Ltd



40 mm x 68 mm x 15 mm SKF 6008 NR deep groove ball bearings

Bearing No. 6008 NR

6008 NR Bearing 2D drawings and 3D CAD models

Size	15x68x61.1 mm
Bore Diameter	15 mm
Outer Diameter	68 mm
Width	61,1 mm
D	68 mm
B	15 mm
D ₂	61.1 mm
D ₃	64.82 mm
D ₄	74.6 mm
b	1.9 mm
C	2.49 mm
f	1.7 mm
r ₀	0.6 mm
r _{1,2} - min.	1 mm
d _a - min.	44.6 mm
D _a - max.	63.4 mm
D _b - min.	76 mm
b _a - min.	2.2 mm
C _a - max.	4.19 mm
r _a - max.	1 mm
Basic dynamic load rating - C	17.8 kN
Basic static load rating - C ₀	11 kN
Fatigue load limit - P _u	0.49 kN
Reference speed	22000 r/min



Air Suspension Bearing Co., Ltd

Limiting speed	14000 r/min
Calculation factor - k_r	0.025
Calculation factor - f_0	15
Mass bearing	0.192 kg
Category	Single Row Ball Bearings
Inventory	0.0
Manufacturer Name	SKF
Minimum Buy Quantity	N/A
Weight / Kilogram	0.209
EAN	7316577736666
Product Group	B00308
Enclosure	Open
Precision Class	ABEC 1 ISO P0
Maximum Capacity / Filling Slot	No
Rolling Element	Ball Bearing
Snap Ring	Yes
Internal Special Features	No
Cage Material	Steel
Internal Clearance	C0-Medium
Inch - Metric	Metric
Long Description	40MM Bore; 68MM Outside Diameter; 15MM Outer Race Width; Open; Ball Bearing; ABEC 1 ISO P0; No Filling Slot; Yes Snap Ring; No Internal Special Features; C0-Medium Internal Clearance; Steel Cage
Other Features	Deep Groove With Snap Ring
Category	Single Row Ball Bearing
UNSPSC	31171504
Harmonized Tariff Code	8482.10.50.68



Air Suspension Bearing Co., Ltd

Noun	Bearing
Keyword String	Ball
Manufacturer URL	http://www.skf.com
Manufacturer Item Number	6008 NR
Weight / LBS	0.4607
Inner Race Width	0 Inch 0 Millimeter
Outer Race Width	0.591 Inch 15 Millimeter
Bore	1.575 Inch 40 Millimeter
Outside Diameter	2.677 Inch 68 Millimeter
d	40 mm
d ₁	49.25 mm
D ₂	61.1 mm
D ₃	64.82 mm
D ₄	74.6 mm
r ₀ max.	0.6 mm
r _{1,2} min.	1 mm
d _a min.	44.6 mm
D _a max.	63.4 mm
D _b min.	76 mm
b _a min.	2.2 mm
C _a max.	4.19 mm
r _a max.	1 mm
Basic dynamic load rating C	17.8 kN
Basic static load rating C ₀	11 kN
Fatigue load limit P _u	0.49 kN
Calculation factor k _r	0.025
Calculation factor f ₀	15
Snap ring	SP 68