

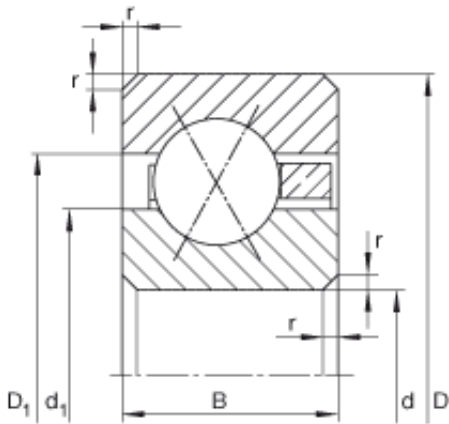

Air Suspension Bearing Co., Ltd

11 inch x 298,45 mm x 9,525 mm INA
CSXC110 deep groove ball bearings

Bearing No. CSXC110



CSXC110 Bearing 2D drawings and 3D CAD models

Size	279.4x298.45x9.525 mm
Bore Diameter	279,4 mm
Outer Diameter	298,45 mm
Width	9,525 mm
d	279,4 mm
d	11 inch
D	298,45 mm
B	9,525 mm
D ₁	291,4 mm
d ₁	286,4 mm
r _{min}	1 mm
m	0,53 kg / Weight
C _r	14800 N / Dynamic load rating (radial)
C _{0r}	38500 N / Static load rating (radial)