

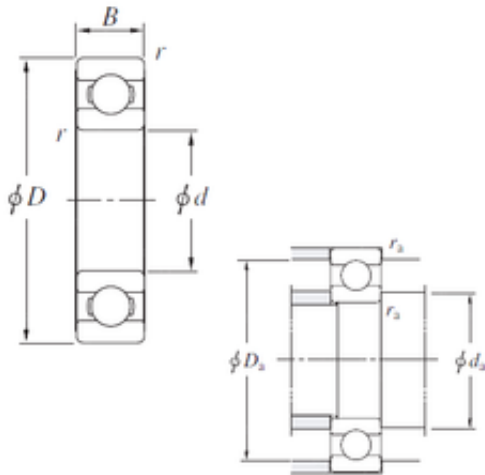

Air Suspension Bearing Co., Ltd



1200 mm x 1450 mm x 112 mm KOYO SB1200
deep groove ball bearings

Bearing No. SB1200

Size	1200x1450x112 mm
Bore Diameter	1200 mm
Outer Diameter	1450 mm
Width	112 mm
d	1200 mm
D	1450 mm
B	112 mm
r min.	7,5 mm
da min.	1232 mm
Da max.	1418 mm
ra max.	6 mm
Weight	363 Kg
Basic dynamic load rating (C)	915 kN
Basic static load rating (C0)	2580 kN

SB1200 Bearing 2D drawings and 3D CAD models